

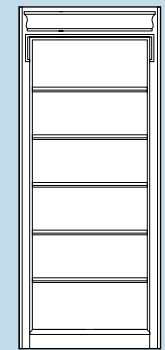

wall system

200

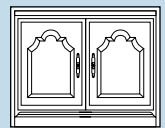
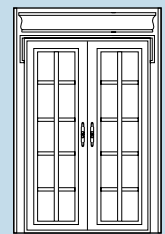
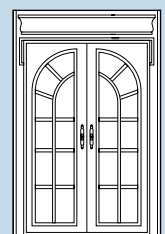
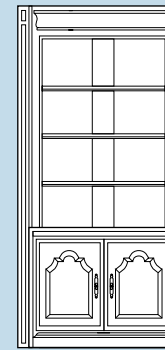
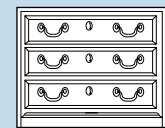
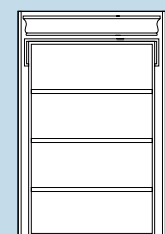
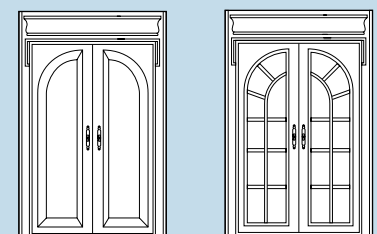

200 WALL SYSTEM WITH HOME THEATER OPTION

- 217 Corner / Tie-in Cabinet
- 216 Top with 218 Wood Style Doors
- 214 Drawer Base
- 208-100 Home Theater Bridge (56" wide custom)
- 208-300 Home Theater Base (56" wide custom)
- 216 Top with 218 Wood Style Doors
- 214 Drawer Base
- 217 Corner / Tie-in Cabinet
- Old Tavern Finish shown.

Please refer to pages 8-11 for additional information and ordering instructions.

200 WALL SYSTEM —

TOP UNITS	BASE UNITS	FULL UNITS	CORNER UNITS	OPTIONS
<ul style="list-style-type: none"> • 34" Wide • 20" Wide • Special top unit options 	<ul style="list-style-type: none"> • 34" Wide • 20" Wide • Special base unit options 	<ul style="list-style-type: none"> • Library Cabinet • Entertainment Center 	<ul style="list-style-type: none"> • Cabinet • Tie-in 	<ul style="list-style-type: none"> • Filler panels • Light bridges • Finished Top Surfaces • Home Theater

HARDEN



228 ENTERTAINMENT CENTER

47 3/4 W 26 1/2 D 84 3/4 H

Two pocket doors. Two hinged doors
Vintage Finish shown.

Please refer to page 70 for additional information.



left to right: 217 Corner / Tie-in Cabinet, 200 Wood Door Top (hinged left), 202 Door Base (hinged left), 228 Entertainment Center, 200 Wood Door Top (hinged right), 202 Door Base (hinged right), 217 Corner / Tie-in Cabinet. Berkshire Finish shown.

HARDEN



left to right: 217 Corner / Tie-in Cabinet
 216 Glass Door Top
 214 Drawer Base
 217 Corner / Tie-in Cabinet
 218 Wood Door Top
 210 Wood Door Base
 217 Corner / Tie-in Cabinet
 200 1/2 Wood Door Top (hinged left)
 204 Wood Door Base (hinged left)
 217 Corner / Tie-in Cabinet
 Pine Shops Finish shown.

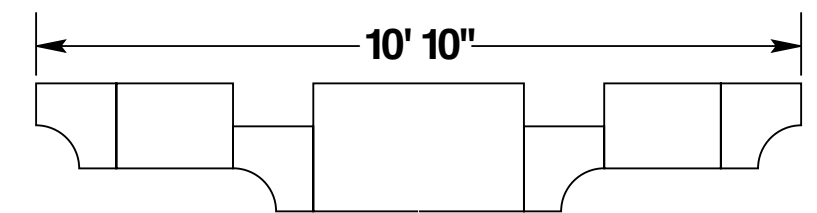
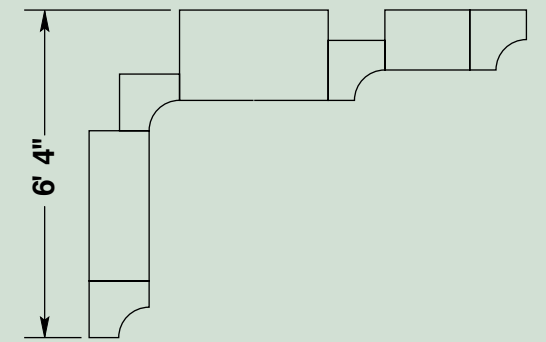

left to right: 217 Corner / Tie-in Cabinet
 205 1/2 Glass Door Top (hinged left)
 204 Wood Door Base (hinged left)
 217 Corner / Tie-in Cabinet
 218 Wood Door Top
 210 Wood Door Base
 217 Corner / Tie-in Cabinet
 205 1/2 Glass Door Top (hinged right)
 204 Wood Door Base (hinged right)
 217 Corner / Tie-in Cabinet.
 Vintage Finish shown.

HARDEN

TOP UNIT OPTIONS

OPTIONAL DOOR TREATMENTS

Available for 34" wide top units either 21" or 14" deep.

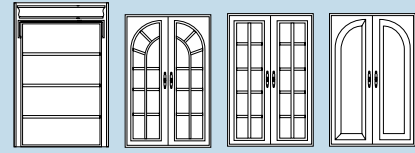

Full Shelf Cabinet No Doors
212 Style Doors
216 Style Doors
218 Style Doors

WOOD SHELVES

Solid wood shelves with display groove.

- 31 Wood Shelves for 34"W x 14"D top units
- 31 1/2 Wood Shelves for 20"W x 14"D top units
- 32 Wood Shelves for 34"W x 21"D top units
- 32 1/2 Wood Shelves for 20"W x 21"D top units

LOCKS

Two styles of locks are available on any 21" or 14" deep top unit.

- 44 Decorative Cabinet Lock
Decorative key and keyhole plate
- 45 Cylinder Lock
May be keyed to match other items ordered

FINISHED VENTED TOP

A finished plywood top with air vents for lights may be ordered on any top unit. Specify for each top unit ordered.

LIGHT BRIDGES

Units feature recessed lighting with rheostat dimmer switch and are designed for use with either 21" or 14" deep top units. No more than three 34" units should be used together without additional support.



208 Light Bridge
34W 14D 7 1/2 H



208 1/2 Light Bridge
20W 14D 7 1/2 H

208-100 Home Theater Light Bridge — See page 71

FILLER PANELS

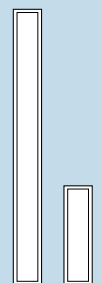

Filler panels can be ordered in custom widths from 3" to 7" in order to arrange wall units to fit room's exact dimensions. Brackets are provided for ease of installation.

- 42 Full Length Filler Panel
80H — 3" to 7" wide, specify width
- 43 Short Filler Panel
28H — 3" to 7" wide, specify width

TOP UNITS

Top units are equipped with a built-in electrical outlet (3 plugs), recessed lighting fixture and rheostat dimmer switch. Tops are open with light fixture exposed. If finished top is desired, see "Finished Vented Top" option at left.

34" WIDE STANDARD TOP UNITS

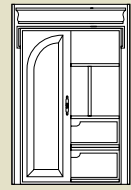

- 207 Wood Door Top with Wardrobe Interior**
34W 21D 52H
- Two drawers
 - Two shirt dividers
 - One stationary shelf
 - Mirror on left facing door
 - Tie rack on right facing door

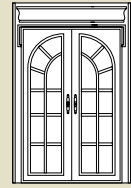

- 212 Glass Door Top**
34W 21D 52H
- Three adjustable glass shelves



- 212 1/2 Glass Door Top with TV Pull-out Shelf**
34W 21D 52H
- Two adjustable glass shelves

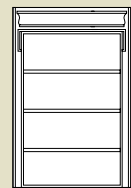

- 215 Shelf Unit**
34W 14D 52H
- Open front
 - Three adjustable glass shelves

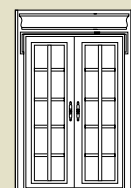

- 216 Glass Door Top**
34W 14D 52H
- Three adjustable glass shelves

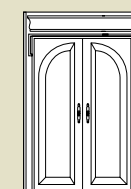

- 218 Wood Door Top**
34W 21D 52H
- Three adjustable glass shelves

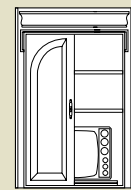

- 218 1/2 Wood Door Top with TV Pull-out Shelf**
34W 21D 52H
- Two adjustable glass shelves



- 219 Wood Door Top with Bar Unit**
34W 21D 52H
- Mirror lined back
 - Overhead racks
 - Side glass shelves
 - Utensil drawer
 - Black Formica® on pull-out shelf and working surface
 - 44 Decorative Cabinet Lock standard

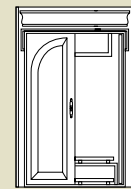

- 221 Wood Pocket Door Top with TV and VCR Shelf**
34W 21D 52H
- TV Compartment — 24 W 19D 34H
 - VCR Pull-out Shelf — 26W 17 1/2 D 6H

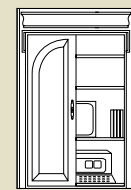

- 227 Wood Door Top with Computer Interior**
34W 21D 52H
- Three adjustable wood shelves with one slotted for printer paper
- Note: pull-out keyboard shelf is ordered as part of base cabinet. (See Base Units)

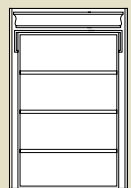

- 229 Shelf Unit**
34W 21D 52H
- Open front
 - Three adjustable glass shelves

20" WIDE STANDARD TOP UNITS

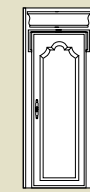

- 200 Wood Door Top**
20W 21D 52H
- Three adjustable glass shelves
- Standard with door hinged on right. Door may be special ordered to be hinged left.

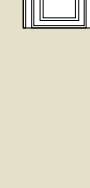

- 200 1/2 Wood Door Top**
20W 14D 52H
- Same as 200 Wood Door Top, except 14D.

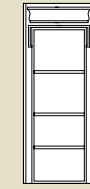

- 203 Shelf Unit**
20W 21D 52H
- Open front
 - Three adjustable glass shelves



- 205 Shelf Unit**
20W 14D 52H
- Same as 203 Shelf Unit, except 14D.



- 203 1/2 Glass Door Top**
20W 21D 52H
- Three adjustable glass shelves
- Standard with door hinged on right. Door may be special ordered to be hinged left.

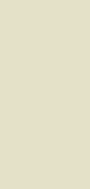

- 205 1/2 Glass Door Top**
20W 14D 52H
- Same as 203 1/2 Glass Door Top, except 14D.

BASE UNITS

34" WIDE STANDARD BASE UNITS



- 209 Drawer Bridge**
34W 21D 4 1/2 H
- Connects between 21" deep base units. Must be used with finished top surface.



- 209 1/2 Keypad Drawer Bridge**
34W 21D 4 1/2 H
- Drawer face drops to reveal pull-out keypad. Must be used with finished top surface.



- 210 Wood Door Base**
34W 21D 28H
- One adjustable wood shelf



- 213 Wood Door Base**
34W 14D 28H
- Same as 210 Wood Door Base, except 14D.

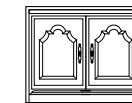

- 210 1/2 TV Cabinet Base**
34W 21D 28H
- One pull-out TV shelf
 - Built-in electrical outlet

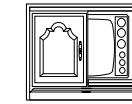

- 211 Drawer Base**
34W 21D 28H
- Three box drawers
- Keyhole plates are decorative only.

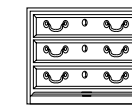

- 214 Drawer Base**
34W 14D 28H
- Same as 211 Drawer Base, except 14D.



- 211 1/2 Drawer Base**
34W 21D 28H
- Top file drawer with cylinder lock
 - Bottom box drawer
 - Accuride® glides



- 214 1/2 Drawer Base**
34W 14D 28H
- Same as 211 1/2 Drawer Base, except 14D.

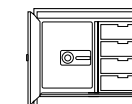

- 220 Safe Unit Base**
34W 21D 28H
- Built-in Sentry® safe
 - Four tray drawers

20" WIDE STANDARD BASE UNITS



- 202 Wood Door Base**
20W 21D 28H
- One adjustable shelf
- Standard with door hinged on right. Door may be special ordered to be hinged left.

- 204 Wood Door Base**
20W 14D 28H
- Same as 202 Door Base, except 14D.

BASE UNIT OPTIONS

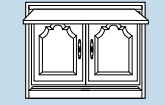

- 41 Pull-out Formica® Shelf**
24 1/2 W 18 1/2 D 28H from floor
- Pull-out shelf to be used as writing surface or keypad tray. Available on 21" deep base units with doors or drawers.

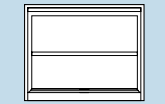

- Full Shelf Cabinet / No Doors**
Available on 21" deep base units with doors.

LOCKS

Two styles of locks are available on any 21" and 14" deep base unit.

- 44 Decorative Cabinet Lock
Decorative key and keyhole plate
- 45 Cylinder Lock
May be keyed to match other items ordered.

FINISHED TOP SURFACES

A finished top surface is required whenever a base unit is used alone, a 209 or 209 1/2 Drawer Bridge is ordered, or a shallow (14") top is used with a deep (21") base.

20" WIDE TOP

- 33 1/2 Installs on 14" deep base unit
- 34 1/2 Installs on 21" deep base unit

34" WIDE TOP

- 33 Installs on 14" deep base unit
- 34 Installs on 21" deep base unit

68" WIDE TOP

- 35 Installs on two 14" deep base units
- 36 Installs on two 21" deep base units

102" WIDE TOP

- 37 Installs on three 14" deep base units
- 38 Installs on three 21" deep base units

Note: When used between a top and base unit the overall height is increased. In order for other units to match, a finished top surface must be installed on each base unit and a special adapter, 56, must be installed on the bottom of each 217 Corner/Tie-in Unit.

56 Special Height Adapter

Use with a 217 Corner/Tie-in Cabinet to raise height when a finished top surface is placed between an adjoining top and base.



200 wall system

FULL UNITS

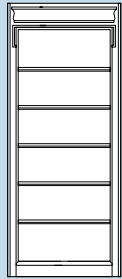

240 Library Cabinet
34W 14D 80H
• Five adjustable glass shelves
• Interior lighting
Can be used as an add-on or freestanding unit.

240-4 Wood Shelves
May be ordered as an option with 240 Library Cabinet.

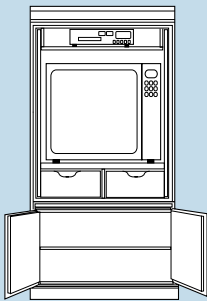

228 Entertainment Center
47 3/4 W 26 1/2 D 84 3/4 H

Top section —
• Two pocket doors
• Behind doors —
- VCR opening — 35W 19 1/2 D 6H
- TV opening — 38W 23 1/4 D 32H
- two pull-out drawers
- knock-out back panel for ventilation

Bottom section —
• Two hinged doors
• Behind doors —
- one adjustable wood shelf

Can be used as an add-on or freestanding unit with the 200 Wall System.
Two section construction.

CORNER / TIE-IN UNITS

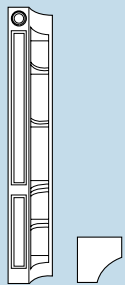

217 Corner/Tie-in Cabinet
14W 14D 80H
• Five curved wood shelves

Serves as a tie-in for corner configurations, a step-back between deep (21") and shallow (14") units, or as an end cap. It may also be used as a corner cabinet.

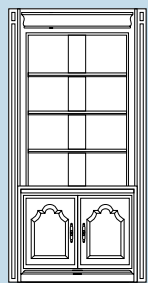

269 Corner Cabinet
31W 21D 80H
• Three glass shelves in top
• One adjustable wood shelf in base

Serves as end cap for deep (21") units, or as a corner cabinet.

269-4 Wood Shelves
May be ordered as an option with 269 Corner Cabinet.



221 Pocket Door Top



219 Bar Unit



227 Computer Cabinet and 211 Drawer Base with 41 Pull-out Formica Shelf



211 1/2 Drawer Base



210 1/2 TV Cabinet



220 Safe Unit



45 Cylinder Lock



44 Decorative Cabinet Lock



200 WALL SYSTEM WITH HOME THEATER OPTION

left to right: 217 Corner / Tie-in Cabinet, 216 Top with 218 Wood Style Doors, 214 Drawer Base, 208-100 Home Theater Bridge (56" wide custom), 208-300 Home Theater Base (56" wide custom), 216 Top with 218 Wood Style Doors, 214 Drawer Base, 217 Corner / Tie-in Cabinet. Old Tavern Finish shown.

HOME THEATER UNITS — CUSTOMIZED OPTIONS

The 208-300 / 208-400 Home Theater Bases and 208-100 Home Theater Bridge are available in **CUSTOMIZED WIDTHS FROM 50" TO 70"**. The number of base units and filler panels required will depend upon the width of the Home Theater Unit ordered. It will be necessary to contact the factory for specific information.

208-100 HOME THEATER LIGHT BRIDGE

- recessed rheostat lighting
- bookshelf/VCR storage
- 1 3/4" access hole for wires bored in shelf

Width and height of the overall unit will vary depending on size of TV.

As a standard, the factory will make overall width 2" wider than TV and overall height will be adjusted to allow 1" of clearance for TV to slide into. May be used with most of the 200 Wall System components.

When purchased with 21" deep units there will be a 7" space between the wall and the back of the 208-100 Home Theater Light Bridge for heat dissipation.

208-300 HOME THEATER BASE

14D 28 3/4 H Width will vary depending on overall size of TV. Consists of Base Units, Filler Panels and Finished Top Surface.

208-400 HOME THEATER BASE

21D 28 3/4 H Width will vary depending on overall size of TV. Consists of Base Units, Filler Panels and Finished Top Surface.

HARDEN